

KEY:

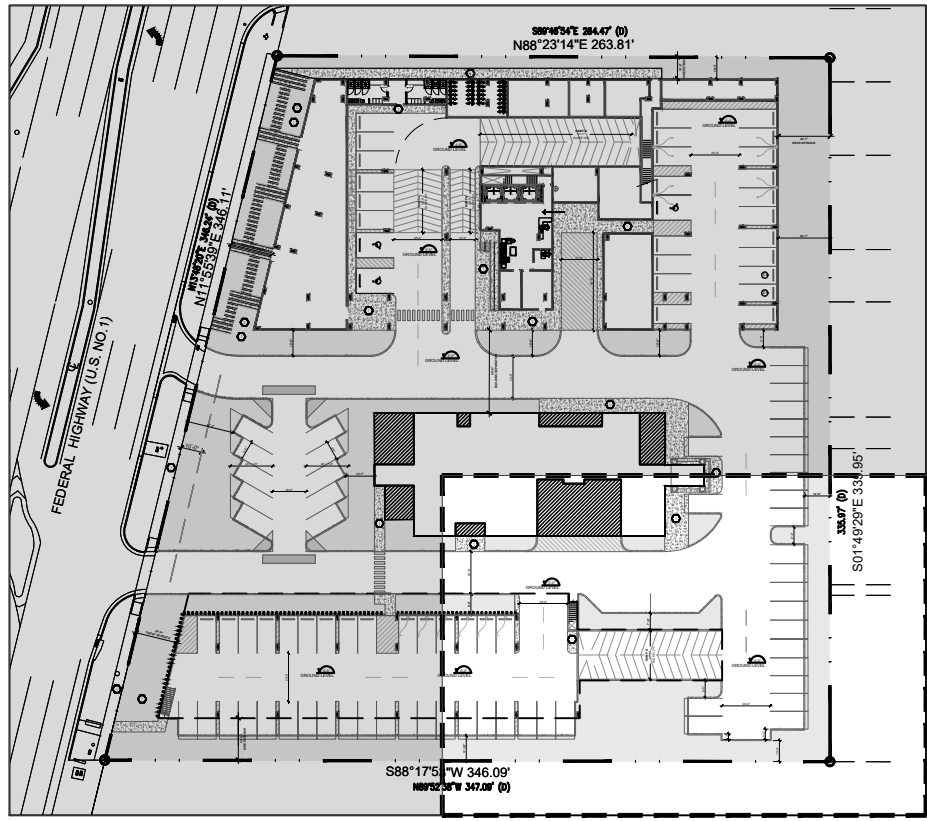

**absolute-idea.com**  
CANAL PARK  
3323 NE 163rd Street, Suite 200 North Miami Beach, FL 33160  
1 305.792.0015 1 305.931.0279 @info@absolute-idea.com

SEAL  
KEN GARDNER  
FLA 1569

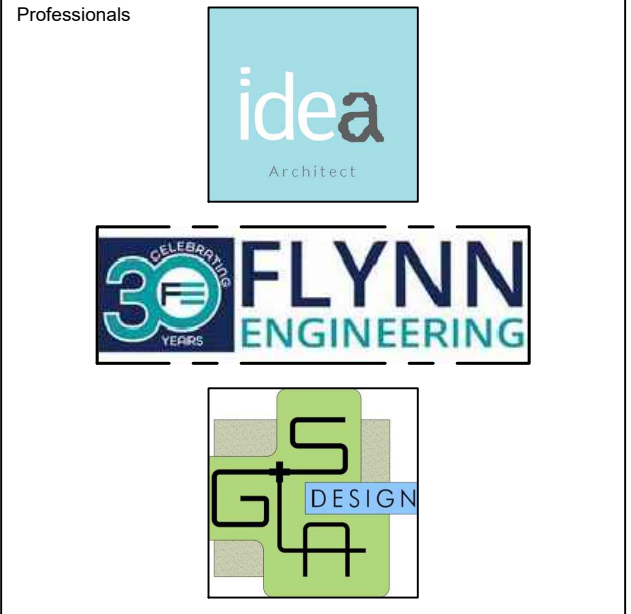

REV.	DATE	DESCRIPTION
01	XX-XX-2024	D.R.C SUBMITAL

ALL MEASUREMENTS MUST BE VERIFIED BEFORE BEGINNING THE WORKS. NO MEASUREMENTS ARE TO BE SCALED DIRECTLY FROM THIS DRAWING.

Key section

Client  
**VERA FUND**  
NICK POLYUSHKIN  
& YURI KHARITONENKOV  
TEL: 305.833.3303

Project  
**1600 S FEDERAL HIGHWAY  
(MIXED-USE PROJECT)**  
1600 SOUTH FEDERAL HIGHWAY,  
POMPANO BEACH, FL 33062

Title PLANTING PLAN GROUND FLOOR	
Drawn <b>GSLA</b>	Field <b>LANDSCAPE ARCH</b>
Verified <b>KG</b>	Scale <b>as shown</b>
Approved <b>KG</b>	Date <b>10-09-2024</b>
Project Manager <b>KG</b>	Dwg. no. <b>L-204</b>
Project <b>24-838</b>	

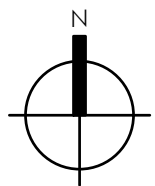

PLANTING PLAN - GROUND FLOOR

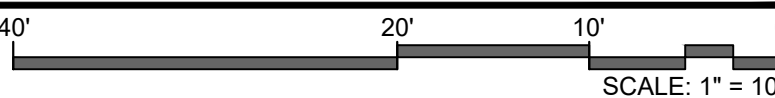

1  
L204

